

QUICKLY INSTALLATION GUIDE

DYNESS Smart ESS APP

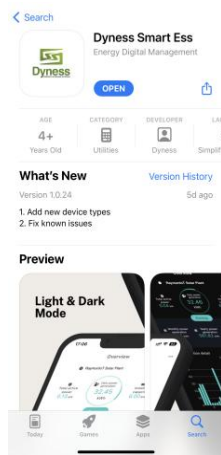

- 1 Download the Dyness Smart ESS App from the App Store (iOS devices) or Google Play (Android devices).



IOS devices



Android

- 2 Registration & Login

Users who download and use Dyness Smart Ess for the first time need to register.

First, click "Sign Up", enter the registration page. Then, fill in the information to complete the registration:

- Fill in your email

Please follow the prompts to enter your email account correctly and send and fill in the verification code;

- Improve account information

If this account is the first time to register the APP client, you need to improve the account information;

Please enter your name and password, and confirm;

- Improve user information

Please follow the prompts to select the user timezone; Telephone number optional; The organization code is **EC03B0**. Please check the box in the Agreement column to indicate that you have agreed to the Service Agreement and the Privacy Agreement;

Login: Fill in the correct "Username/Email" and "Password", and login to Dyness Smart Ess

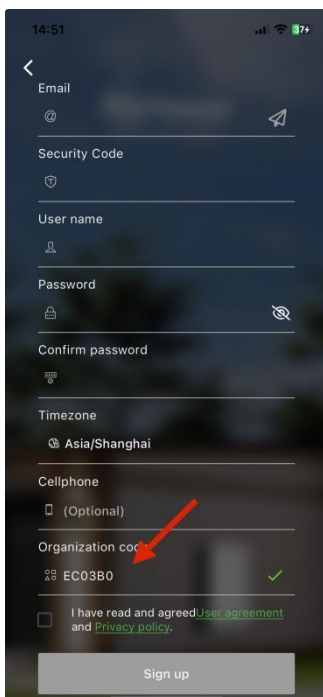

Login

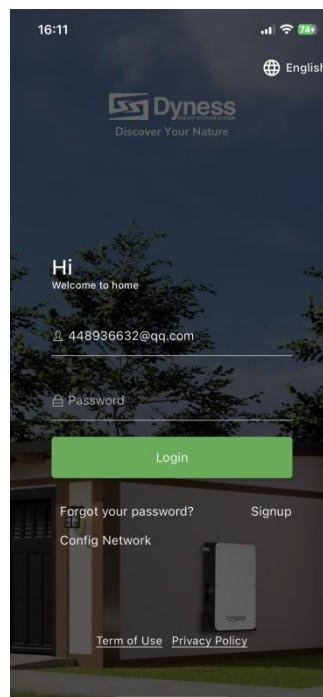

3 Create Plant

Click 'Plants', and click the '...' at the top right to select 'Create Plants' to enter the power station creation

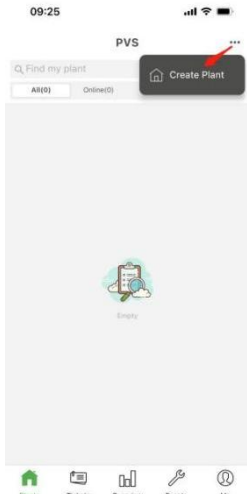

4 Fill in the information such as Business Type and Plant Type, click "Finish" to complete the creation of plant

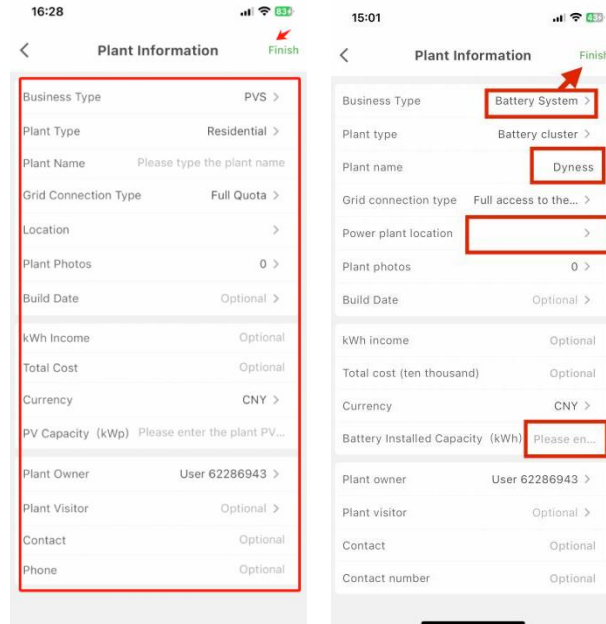

5 Add Device

Click the "Add collector" button below the power station, scan the QR code of the device to add (see Step 1 of the "WiFi Configuration" below), or enter the serial number to add, after the correct input of the serial number, the collector will be displayed as successfully added. Tip: Click "Confirm" to jump directly to the distribution network interface, see Step 2 of the "WiFi Configuration" below.

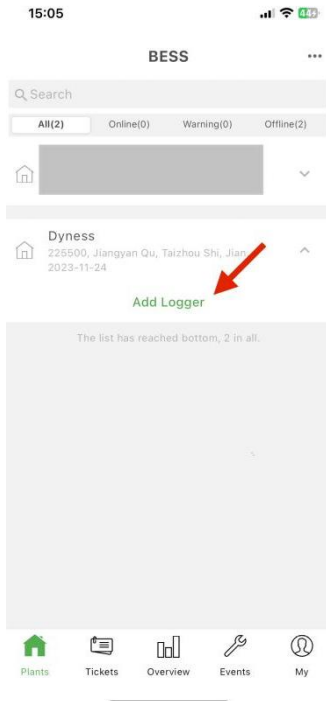

6 WiFi Configuration

Step1 : WIFI distribution network, use Dyness smart ESS app to scan the QR code in the Wi-Fi Logger label.

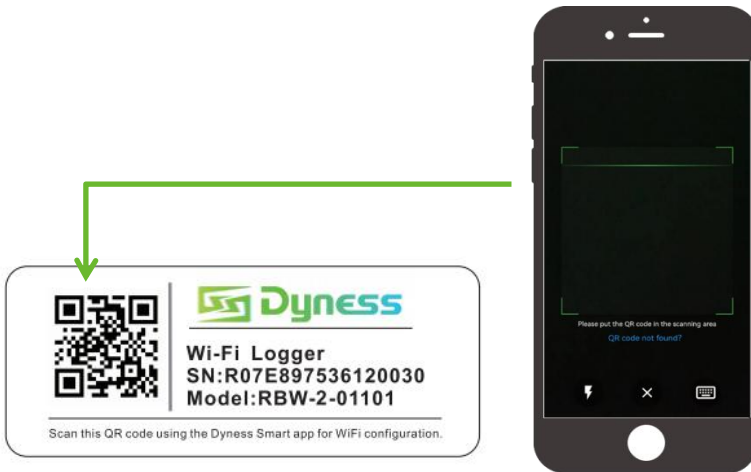

Step2: Open the APP and switch to the "Me" page after login, Click "Config Network", select the wireless network, enter the password, and scan the SN number of the collector to be distributed. Click the "Start Config" button to configure the network, and wait for the configuration to succeed.

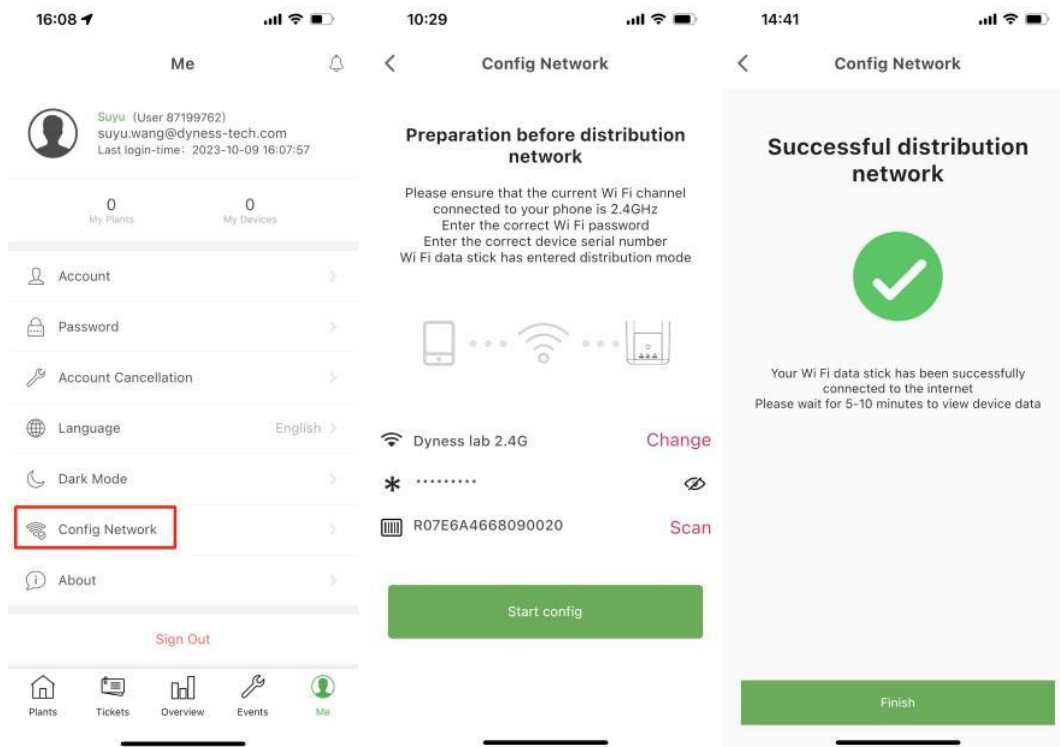

7 View battery information

After successful network configuration, wait for 5~10 minutes, return to "Plants" interface, Click on the dropdown button of the collector as below, then you can see **BMS** information; click the BMS that you can see more information of the battery as below.

The screenshots illustrate the following steps:

- Plant List:** A list of plants under the 'BESS' header. 'DyNESS Suzhou' is highlighted with a green box and a red arrow pointing to its dropdown arrow.
- Collector Selection:** The 'Collector' dropdown menu is open, showing '100.0% BMS' with a red arrow pointing to its right-pointing arrow.
- Battery Overview:** A large green circular gauge displays '100%'.
- Charge-Discharge Section:**

Charge-Discharge

SOC:	SOH:
100.0	100.0
Remaining Battery Power:Rated Battery Capacity:	
10.65 kWh	10.65 kWh
Suggested Charging Current:	
5.5 A	22.2 A
Suggested Discharge Current:	
3.335 v	36
Minimum Single Pressure Value:	
3.325 v	

Temperature

Maximum Temperature Value:	Minimum Temperature Value:
22.0 °C	18.0 °C
- Basic Information Section:**

Battery: R07E6A4668090028-BDU-01

Basic Information

BMS_ SN:
R07E6A4668090028-BDU

PACK_ SN:
R07E6A4668090028-BDU-01

Current Serial Number:
1

Number Of Individual Voltages:
30

Number Of Individual Temperatures:
2.0

VDiff				
1	2	3	4	5
3.33 v	3.33 v	3.33 v	3.33 v	3.33 v
6	7	8	9	10
3.33 v	3.33 v	3.33 v	3.33 v	3.33 v
11	12	13	14	15
3.33 v	3.33 v	3.33 v	3.33 v	3.33 v
16	17	18	19	20
3.33 v	3.33 v	3.33 v	3.33 v	3.33 v
21	22	23	24	25
3.33 v	3.33 v	3.33 v	3.33 v	3.33 v
26	27	28	29	30
3.33 v	3.33 v	3.33 v	3.33 v	3.33 v

Monomer Differential Pressure
0.00 v

8

User authorization

Please click the "Plant Visitor" column to enter the email number of the user to be authorized and add it as shown in the figure below to authorize the user.

Select the Plant that you need to authorize--->Click "... "---->Click "Edit"---->Click the "Plant Visitor" column--->Add the user--->Click "Finish"---->Click "Finish"---->Display successful

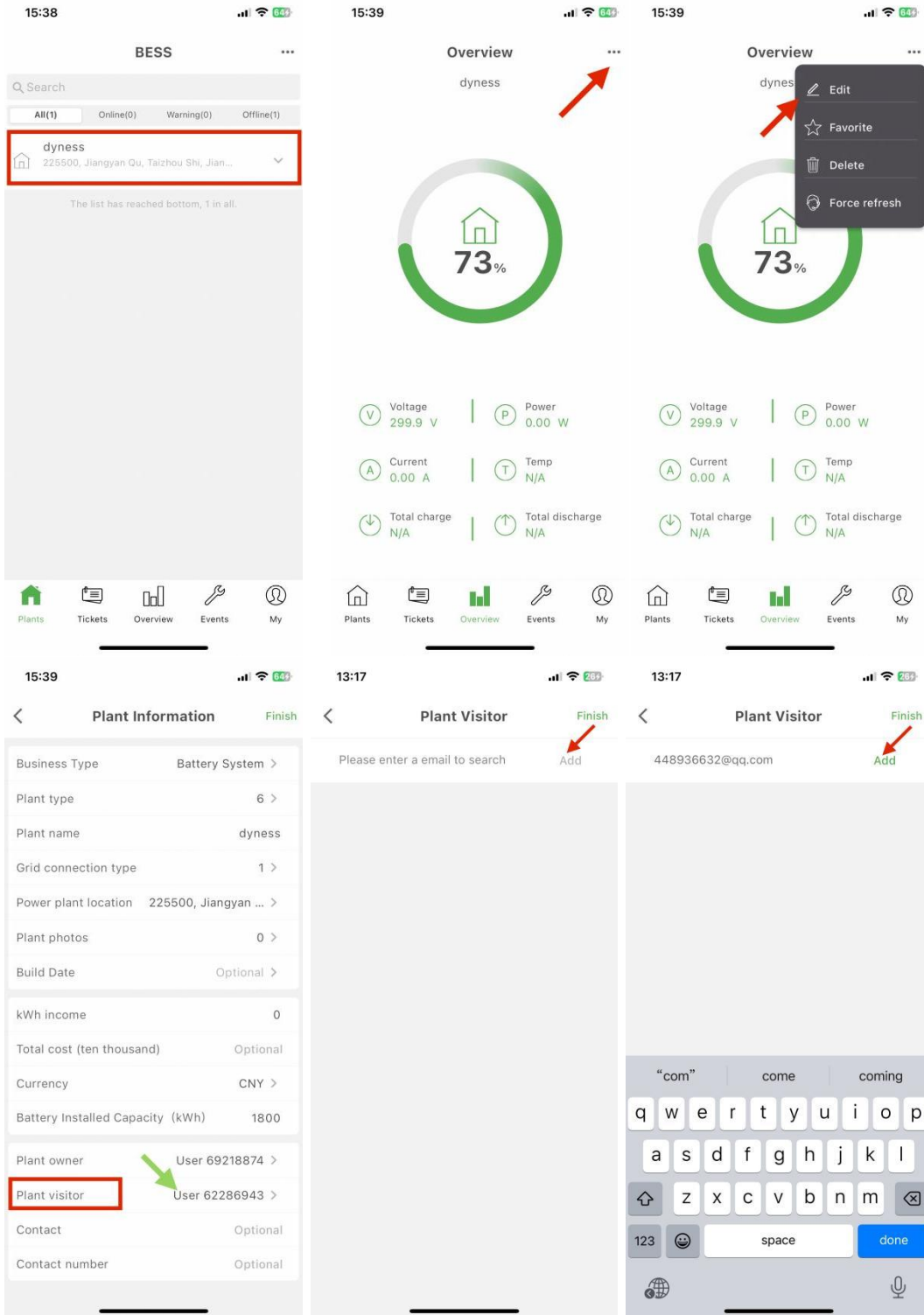

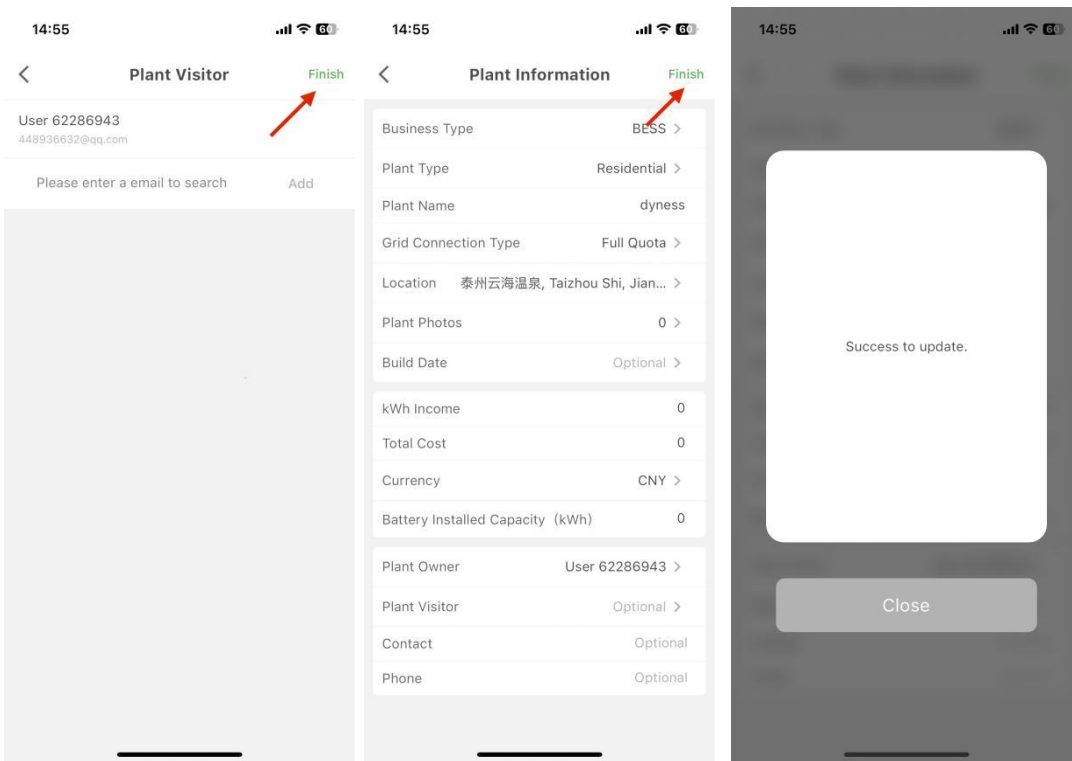

9 Set data permissions for users with different roles (Only the person in charge has this permission)
 Login Website: <https://server.dyness.com/index>

① For End user

Click "Organization"--->Click "Set of points"--->select the "End User Group" column and click "Station allocation"--->Select "BMS-Dyness- High pressure" under Assigned---> Select the information that do not want end users to see on the APP, such as the number of cycles and Click "Remove" button--->Display "Removed successfully" and you can see the one you just removed on the left

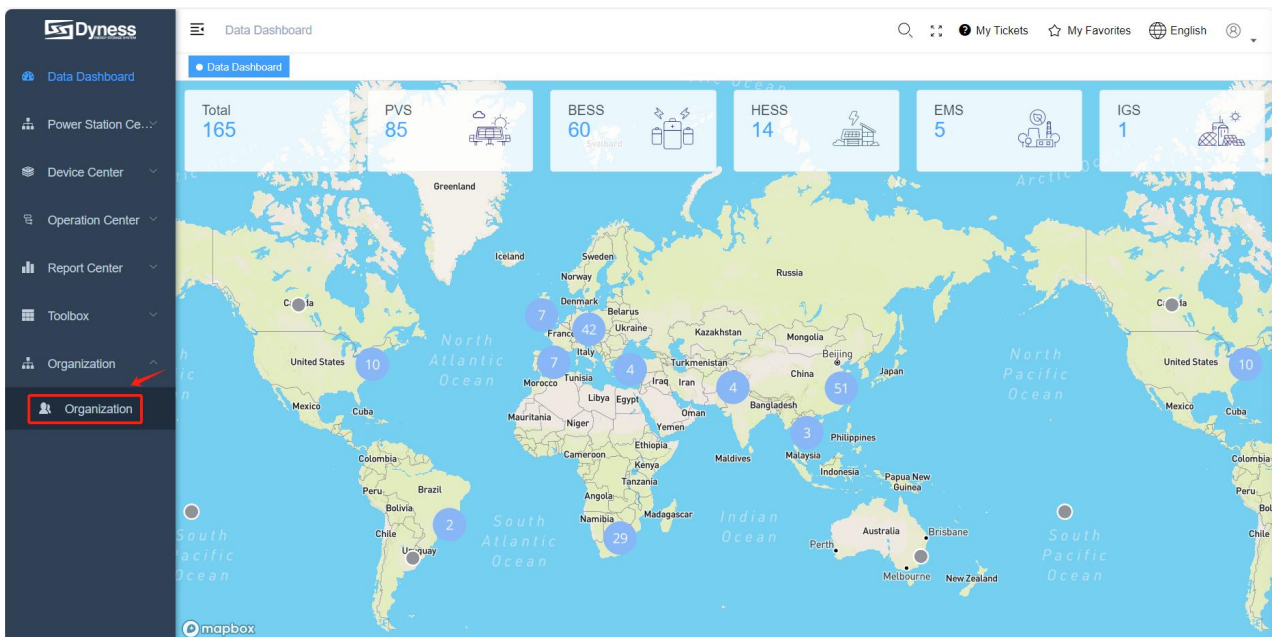

Dyness Data Dashboard / Organization / Organization

Organization

Member List Organization Information **Measurement Group** + New Group

Name

End User Group [Distribution Of Measurement Points](#)

All point sets [Distribution Of Measurement Points](#) [Modify](#) [Delete](#)

大聚新能源科技(泰州)有限..

Dyness Data Dashboard / Organization / Organization

Organization

Member List Organization Information **Measurement Group** + New Group

Name

End User Group [Distribution Of Measurement Points](#)

All point sets [Distribution Of Measurement Points](#) [Modify](#) [Delete](#)

大聚新能源科技(泰州)有限..

Dyness Data Dashboard / Organization / Organization

Distribution Of Measurement Points

Unassigned BMS / Dyness / High Volt...

Measuring Point ID	Alarm type	Name
<input type="checkbox"/>		Bdu Serial Number
<input type="checkbox"/>		Pcb Serial Number
<input type="checkbox"/>		Boot Version Number
<input type="checkbox"/>		Hardware Version Number
<input type="checkbox"/>		App Version Number
<input type="checkbox"/>		Current
<input type="checkbox"/>		Total Pressure
<input type="checkbox"/>		Battery Status
<input type="checkbox"/>		Relay Status
<input type="checkbox"/>		SOC
<input type="checkbox"/>		SOH
<input type="checkbox"/>		Remaining Battery Power
<input type="checkbox"/>		Rated Battery Capacity
<input type="checkbox"/>		Number Of Battery Cycles

Assigned BMS / Dyness / High Volt...

- Batteries > Dyness > Low Voltage
- BMS > High Voltage
- Logger >

No Data

Close < Remove Add >

Unassigned Please select device type

Measuring Point ID	Alarm type	Name

No Data

Assigned BMS / Dyness / High Volt...

Measuring Point ID	Alarm type	Name
<input type="checkbox"/>		10 Bdu Serial Number
<input type="checkbox"/>		20 Pcb Serial Number
<input type="checkbox"/>		30 Boot Version Number
<input type="checkbox"/>		40 Hardware Version Number
<input type="checkbox"/>		50 App Version Number
<input type="checkbox"/>		1000 Current
<input type="checkbox"/>		1100 Total Pressure
<input type="checkbox"/>		1200 Battery Status
<input type="checkbox"/>		1300 Relay Status
<input type="checkbox"/>		1400 SOC
<input type="checkbox"/>		1500 SOH
<input type="checkbox"/>		1600 Remaining Battery Power
<input type="checkbox"/>		1700 Rated Battery Capacity
<input checked="" type="checkbox"/>		1800 Number Of Battery Cycles

Close **Remove** Add

Removed successfully

Unassigned BMS / Dyness / High Volt...

Measuring Point ID	Alarm type	Name
<input type="checkbox"/>		1800 Number Of Battery Cycles

Assigned BMS / Dyness / High Volt...

Measuring Point ID	Alarm type	Name
<input type="checkbox"/>		10 Bdu Serial Number
<input type="checkbox"/>		20 Pcb Serial Number
<input type="checkbox"/>		30 Boot Version Number
<input type="checkbox"/>		40 Hardware Version Number
<input type="checkbox"/>		50 App Version Number
<input type="checkbox"/>		1000 Current
<input type="checkbox"/>		1100 Total Pressure
<input type="checkbox"/>		1200 Battery Status
<input type="checkbox"/>		1300 Relay Status
<input type="checkbox"/>		1400 SOC
<input type="checkbox"/>		1500 SOH
<input type="checkbox"/>		1600 Remaining Battery Power
<input type="checkbox"/>		1700 Rated Battery Capacity
<input type="checkbox"/>		1900 Accumulated Charging Capacity

Close **Remove** Add

② **For other roles, Administrator/Operation Manager/Operation and Maintenance User/Installer/General User/Marketing Staff**

You need to add New group, then click "Station allocation"--->Select "BMS---Dyness--- High pressure" under Undistributed--->Select the information that want the role to see on the APP and Click "Add" button--->Display "Add successfully" and you can see the one you just added on the right

Note: If you want these roles have same data permissions, then you only need to create one new group

Dyness Data Dashboard / Organization / Organization

My Tickets My Favorites English

Organization

Organization

Member List Organization Information **Measurement Group** [+ New Group](#)

Name

End User Group [Distribution Of Measurement Points](#)

All point sets [Distribution Of Measurement Points](#) [Modify](#) [Delete](#)

Dyness Data Dashboard / Organization / Organization

My Tickets My Favorites English

Measurement Group

* Name (Default)

Name (Chinese)

Name (English)

Name (Portuguese)

pointGroup.groupName(cs)

pointGroup.groupName(de)

Dyness Data Dashboard / Organization / Organization

My Tickets My Favorites English

Organization

Organization

Member List Organization Information **Measurement Group** [+ New Group](#)

Name

End User Group [Distribution Of Measurement Points](#)

All point sets [Distribution Of Measurement Points](#) [Modify](#) [Delete](#)

Dyness | Data Dashboard / Organization / Organization

Distribution Of Measurement Points

Unassigned | BMS / Dyness / High Voltage

<input type="checkbox"/>	Batteries	>	Dyness	>	Low Voltage
<input type="checkbox"/>	BMS	>			Junior Box
<input type="checkbox"/>	Logger	>			High Voltage

Assigned | BMS / Dyness / High Volt...

Measurin g Point I D	Alarm typ e	Name
No Data		

Close < Remove Add >

Dyness | Data Dashboard / Organization / Organization

Distribution Of Measurement Points

Unassigned | BMS / Dyness / High Volt...

Measurin g Point I D	Alarm typ e	Name
<input type="checkbox"/>		30 Boot Version Number
<input checked="" type="checkbox"/>		40 Hardware Version Number
<input checked="" type="checkbox"/>		50 App Version Number
<input type="checkbox"/>		1000 Current
<input type="checkbox"/>		1100 Total Pressure
<input checked="" type="checkbox"/>		1200 Battery Status
<input type="checkbox"/>		1300 Relay Status
<input checked="" type="checkbox"/>		1400 SOC
<input checked="" type="checkbox"/>		1500 SOH
<input checked="" type="checkbox"/>		1600 Remaining Battery Power
<input checked="" type="checkbox"/>		1700 Rated Battery Capacity
<input checked="" type="checkbox"/>		1800 Number Of Battery Cycles
<input type="checkbox"/>		1900 Accumulated Charging Capacity
<input type="checkbox"/>		2000 Suggested Charging Current

Assigned | BMS / Dyness / High Volt...

Measurin g Point I D	Alarm typ e	Name
No Data		

Close < Remove Add >

Dyness | Data Dashboard / Organization / Organization

✔ Added successfully

Distribution Of Measurement Points

Unassigned | BMS / Dyness / High Volt...

Measurin g Point I D	Alarm typ e	Name
<input type="checkbox"/>		30 Boot Version Number
<input type="checkbox"/>		40 Hardware Version Number
<input type="checkbox"/>		50 App Version Number
<input type="checkbox"/>		1000 Current
<input type="checkbox"/>		1100 Total Pressure
<input type="checkbox"/>		1200 Battery Status
<input type="checkbox"/>		1300 Relay Status
<input type="checkbox"/>		1400 SOC
<input type="checkbox"/>		1500 SOH
<input type="checkbox"/>		1600 Remaining Battery Power
<input type="checkbox"/>		1700 Rated Battery Capacity
<input type="checkbox"/>		1800 Number Of Battery Cycles
<input type="checkbox"/>		1900 Accumulated Charging Capacity
<input type="checkbox"/>		2000 Suggested Charging Current

Assigned | BMS / Dyness / High Volt...

Measurin g Point I D	Alarm typ e	Name
<input type="checkbox"/>		40 Hardware Version Number
<input type="checkbox"/>		50 App Version Number
<input type="checkbox"/>		1200 Battery Status
<input type="checkbox"/>		1400 SOC
<input type="checkbox"/>		1500 SOH
<input type="checkbox"/>		1600 Remaining Battery Power
<input type="checkbox"/>		1700 Rated Battery Capacity
<input type="checkbox"/>		1800 Number Of Battery Cycles

Close < Remove Add >

10 Modify User Role, The detailed steps are as follows:

Select "Member list"--->Select the Member that you need to modify the role--->Click "Modify" under Operation---> Find "Role"---> First you need to click the old role,it's background will turn white---> Then click the role that you want to change,it's background will turn Blue--->Click "Save"--->After successful modification, you can see his new role in the role column

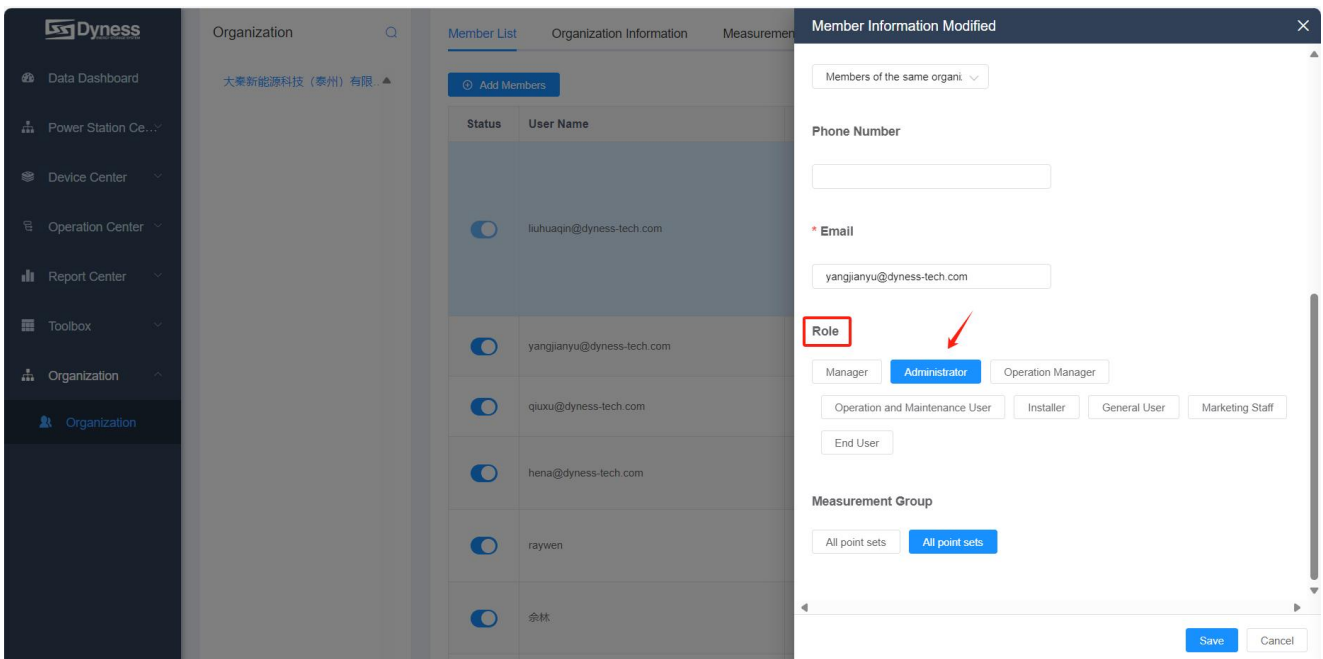
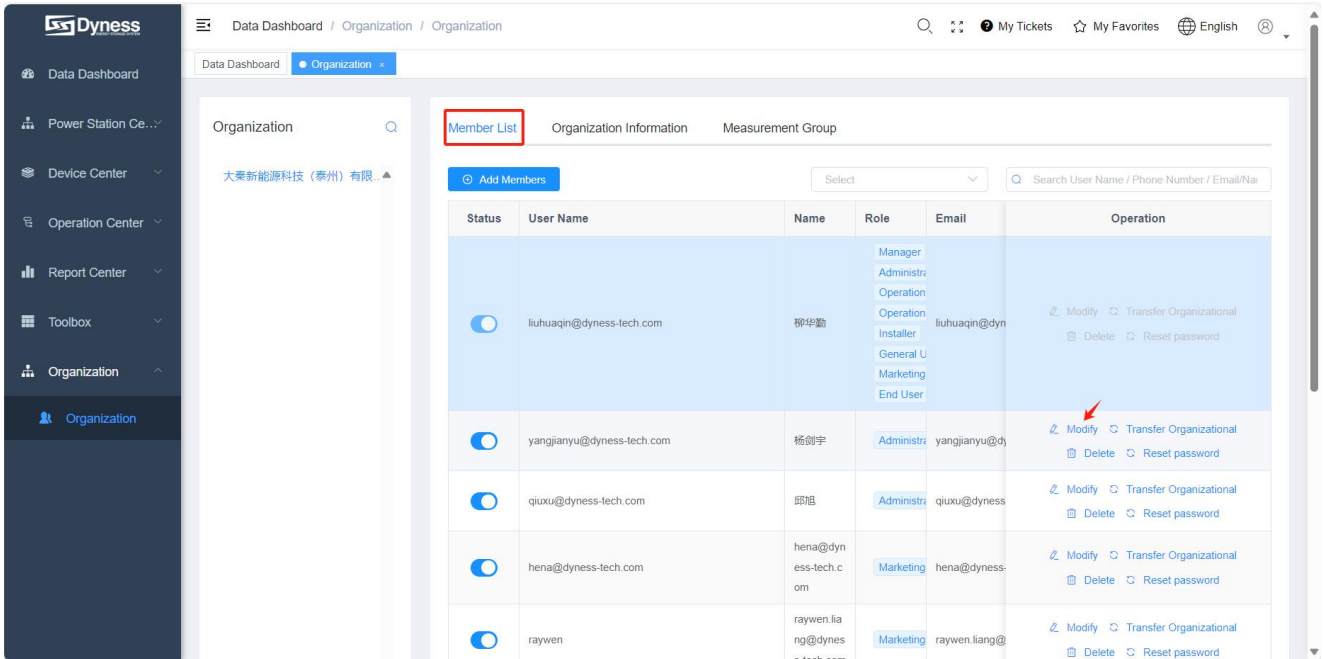

Dyness Organization

Member List Organization Information Measurement Group

Members of the same organi

Phone Number

Email

Role

Manager Administrator **Operation Manager** Operation and Maintenance User Installer General User Marketing Staff End User

Measurement Group

All point sets All point sets

Save Cancel

Dyness Organization

Member List Organization Information Measurement Group

Add Members

Select Search User Name / Phone Number / Email/Name

Status	User Name	Name	Role	En	Operation
<input type="checkbox"/>	liuhuaqn@dyness-tech.com	柳华勤	Manager Administrator Operation Manager Operation and Maintenance Installer General User Marketing Staff End User	liuh	Modify Transfer Organizational Delete Reset password
<input checked="" type="checkbox"/>	yangjianyu@dyness-tech.com	杨剑宇	Operation Manager	yang	Modify Transfer Organizational Delete Reset password
<input checked="" type="checkbox"/>	qiuxu@dyness-tech.com	邱旭	Administrator	qiu	Modify Transfer Organizational Delete Reset password
<input checked="" type="checkbox"/>	hena@dyness-tech.com	hena@dyness-tech.com	Marketing Staff	hena	Modify Transfer Organizational Delete Reset password
<input checked="" type="checkbox"/>	raywen	raywen.liang@dyness-tech.com	Marketing Staff	ray	Modify Transfer Organizational Delete Reset password
<input checked="" type="checkbox"/>	余林	shelin@dyness-tech.com	Administrator	she	Modify Transfer Organizational Delete Reset password

11 OTA of BMS , The detailed steps are as follows:

Select "Logger" ---> Select the Logger that needs to be upgraded (the logger must be on line) ---> Click "Serial Number" of BMS ---> Click "OTA" ---> Find the firmware that needs to be upgraded ---> Click "Upgrade Now" ---> After the upgrade is completed, you can see "Device upgrade succeeded"
Note: 1. The following role types have OTA permissions: "Manager" "Administrator" "Operation Manager" "Operation and Maintenance User" "Installer";

2. when you see "Device upgrade succeeded", the internal upgrade of BMS has not been completed, and this process may last for 5-20 minutes. Please do not power off or restart the battery during this period.

The image shows two screenshots from the Dyness Data Dashboard. The top screenshot displays the 'Logger' page with a table of loggers. The bottom screenshot shows the 'Logger Details Page' for a specific logger.

Logger Page Table:

Status	Serial Number	Firmware Version	Signal Strength	Affiliated Power Plant	Labels	Timezone	Data Update Time	Operation
Online	R07E7A46681B0004	RSW_14002_2_V2.01.102	100%	Dyness suzhou 阳谷	11-17 重新录入	Asia/Shanghai	2024-02-03 09:40	
Online	R07E7A46683201F3	RSW_14002_0_V2.01.58	100%	Dyness Suzhou DL2.5		Asia/Shanghai	2024-02-03 09:38	
Online	R07E7A46681B0052	RSW_14002_2_V2.01.102	37%	dyness_ems	11-17 重新录入	Etc/GMT	2024-02-03 09:41	
Online	R07E7A466813000D	RSW_14002_1_V2.01.95	100%	测试	二合一	Asia/Shanghai	2024-02-03 09:39	
Online	R07E7A4668130005	RSW_14002_1_V2.01.95	100%	Kostal	二合一	Asia/Shanghai	2024-02-03 09:38	
Online	R07E6A4668270014	RSW_14002_0_V2.01.58	100%	Dyness suzhou LV		Etc/GMT	2024-02-03 09:42	

Logger Details Page:

Logger: R07E7A466813000D | Data Update Time: 2024-02-03 09:39 (Asia/Shanghai)

Basic Information:

Serial Number	R07E7A466813000D	Alias Name		Status	Online	Affiliated Power Plant	测试
Firmware Version	RSW_14002_1_V2.01.95	Model	RSW-1-10001	Communication Type	Wi-Fi	Connect Count	1
Signal Strength	100%	Data Upload Interval	300 s				

Associate Subdevices:

BMS

All (1) | Online (1) | Fault (0) | Offline (0)

Status	Serial Number	Total Battery Count	Total Current(A)	Avg SOC(%)	Avg SOH(%)	Affiliated Power Plant	Alias Name	Data Update Time
Online	S4480022311170004		0A	95%	100%	测试		2024-02-03 09:39

Battery System Details Page 54480022311170004 Data Update Time: 2024-02-03 09:44 (Asia/Shanghai) Alarm Unbind ...

Battery: 54480022311170004-01 Data Update Time: 2024-02-03 09:44(Asia/Shanghai)

Basic Information

BMS_SN	54480022311170004	PACK_SN	54480022311170004-01	Current Serial Number	1
Number Of Individual Voltages	30	Number Of Individual Temperatures	2		

Single core voltage1: 3.318 V, Single core voltage2: 3.320 V, Single core voltage3: 3.320 V, Single core voltage4: 3.321 V, Single core voltage5: 3.320 V, Single core voltage6: 3.320 V, Single core voltage7: 3.320 V, Single core voltage8: 3.320 V, Single core voltage9: 3.321 V, Single core voltage10: 3.321 V, Single core voltage11: 3.321 V, Single core voltage12: 3.320 V, Single core voltage13: 3.320 V, Single core voltage14: 3.320 V, Single core voltage15: 3.320 V, Single core voltage16: 3.320 V, Single core voltage17: 3.320 V, Single core voltage18: 3.320 V, Single core voltage19: 3.320 V, Single core voltage20: 3.320 V, Single core voltage21: 3.320 V, Single core voltage22: 3.320 V, Single core voltage23: 3.318 V, Single core voltage24: 3.320 V, Single core voltage25: 3.320 V, Single core voltage26: 3.320 V, Single core voltage27: 3.320 V, Single core voltage28: 3.320 V, Single core voltage29: 3.321 V, Single core voltage30: 3.318 V

differential pressure of the battery: 0.003 V

Temperature1: 13.70°C, Temperature2: 13.90°C

Battery: 54480022311170004-02 Data Update Time: 2024-02-03 09:44(Asia/Shanghai) Unbind fold

- New Ticket
- Config
- Alias Editing
- OTA**
- Operation Log

Battery System Details Page 4668270009 Data Update Time: 2024-02-05 13:53 (Asia/Shanghai)

Basic Information

Bdu Serial Number: 4668270009, Total Pressure: 398.5 v, Number Of Battery Strings Per Box: 30

Charge-Discharge

SOC: 100, Rated Battery Capacity: 14.2 kWh, Maximum Single Pressure Value: 3.322 v

Temperature

Maximum Temperature Value: 16.3 °C

Battery: 4668270009-01 Data Update Time: 2024-02-05 13:53 (Asia/Shanghai)

Basic Information

BMS_SN: 4668270009, Number Of Individual Voltages: 30

OTA

Device Information

Serial Number: 4668270009, Alias Name: , Status: Online, Data Update Time: 2024-02-05 13:53

Firmware Name: Search Reset

Firmware Name	Firmware Version	Extended Info	Note	Update Time
m38gwhv_7369	02	None: does not distinguish...		2024-02-05 13:02
938焊机41	04	None: does not distinguish...	编号4	2024-01-23 14:01
938焊机41	99	None: does not distinguish...	编号1	2024-01-22 13:01
938焊机41	99	None: does not distinguish...		2024-01-22 13:01
938焊机2jinko	09	None: does not distinguish...	编号1	2024-01-22 13:01

Timeout settings for this upgrade: - 15 + Minutes **Upgrade Now** Cancel

Battery System Details Page 54480022311170004 Data Update Time: 2024-02-03 09:44 (Asia/Shanghai)

Basic Information

Bdu Serial Number: 54480022311170004, Total Pressure: 398.3 V, Number Of Battery Strings Per Box: 30

Charge-Discharge

SOC: 95, Rated Battery Capacity: 15.36 kWh, Maximum Single Pressure Value: 3.321 V

Temperature

Maximum Temperature Value: 15.3 °C

Battery: 54480022311170004-01 Data Update Time: 2024-02-03 09:44 (Asia/Shanghai)

Basic Information

BMS_SN: 54480022311170004, Number Of Individual Voltages: 30

OTA

Device Information

Serial Number: 54480022311170004, Alias Name: , Status: Online, Data Update Time: 2024-02-03 09:44

Firmware Name: Search Reset

Firmware Name	Firmware Version	Extended Info	Note	Update Time
938焊机2jinko	01	None: does not distinguish...	编号1	2024-01-18 15:01
938焊机41	05	None: does not distinguish...		2024-01-18 14:01
938焊机2F9	01	None: does not distinguish...		2024-01-18 14:01
938焊机2jinko	03	None: does not distinguish...		2024-01-18 14:01
TowerPro_APP_231220_312	231220312	None: does not distinguish...	自研TowerPro	2023-12-20 17:12

Timeout settings for this upgrade: - 15 + Minutes **Upgrade Now** Cancel

Last operation status

- TowerPro_APP_231220_312 | 231220312 | None: does not distinguish between sequential chips/devices
- 2024-02-03T09:47:29 | OTA command sent to queue.
- 2024-02-03T09:47:29 | Order sent to device.
- 2024-02-03T09:49:50 | Device upgrade succeeded



DISCOVER YOUR NATURE

Address: No. 511 Chenzhuang West Road, Sanshui Street,
Jiangyan District, Taizhou City

Email: service@dyness-tech.com

Tel: +86 400 666 0655

Web: www.dyness-tech.com



Official Website



Digital version access